



Paul Lipke

Chieps Project % T.A.P.

[A Project of M.I.T.'s
Dept of Ocean Engineering / Sea Grant]

4/26/83

Proposed Ship Museum Arrangement

(All credit and permission reserved)

① Ancient Boats and Ships

© Paul R. Lipke

Skills, Skeletons and Sewn Craft Around The World

Contents: models of other early craft, hull development, skulls vs skeletons, etc as related to Khufu ship

② The Find and its Excavation

A Moment's Discovery Leads to Years of Work

Contents: diagram of pyramid/debris/pit, photo's, scale drawings, log book, fiches, what parts where (square diagram), technique

③ Treatment and Restoration

Stabilizing, Repairing & Reshaping the Timbers

Contents: models, pit, all methods, PVA etc.

④ Five Reconstructions

Deciphering a Huge But Delicate Puzzle

Contents: photo's, models, locating techniques, include beam connection, cabin shell location, etc, scale drawings, sketches

⑤ The Shipwrights Craft

A Triumph of Technique and Artistry

Contents: large construction drawings, ship's principal dimensions, materials in it, rope making, tree felling/cutting, length of rope needed to lash, photo's of fine details & finish, largest & smallest pieces

⑥ map of Giza Plateau / boat pits ⑦ Tomb reliefs: Sekhne, Ti, Hetepheret etc.

⑧ details of excavation, quarry marks, ⑨ samples of quarry marks
stone cutting technique - links-on?

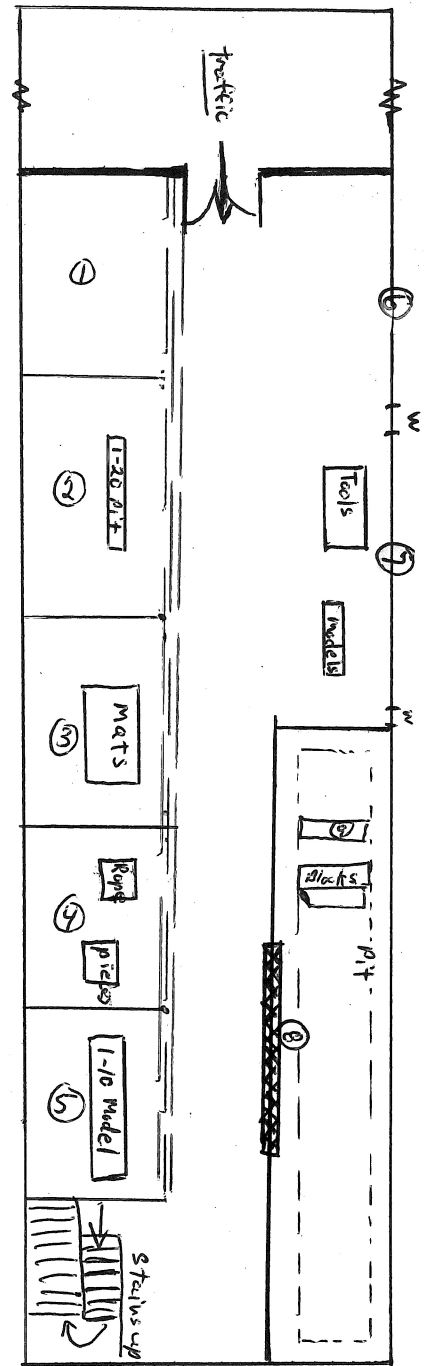

Additional ideas: 3 ^{tear} left

A.V. posts (multilingual) or display panels on catwalks around the

^{ships}
Sell ^{reduced/amended} "lines" drawings / pamphlet as souvenirs

Encapsulate left in French, German, + Italian for a pamphlet(s)
to give to those visitors